

B

B VIEW BOTTOM OF SHELL

SPECIFICATION	VALUE
POWER (Kw)	1.5
VOLTAGE (VAC)	220
RATED CURRENT (A)	6.8
MAXIMUM SPEED (RPM)	18000
FREQUENCY (Hz)	300
NUT MODEL	ER20
COLLET (mm)	Ø6
COOLING	AIR COOLED
MATERIAL	STAINLESS STEEL
LUBRICATION	GREASE
WEIGHT (Kg) [lb]	6.15 [13.56]

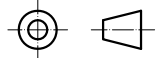
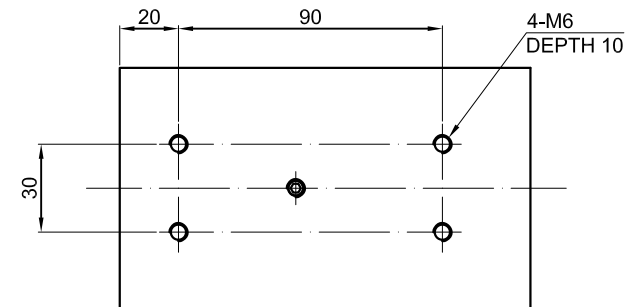

mm	APVD	7.11.2022
UNIT	CHKD	
3:1	DRN	
SCALE	SIGNATURE	DATE

SPINDLE MOTOR

GDZ93×82-1.5B4